

개정 번호 REVISION NO.	개정 내용 DESCRIPTION	날짜 DATE
V 1.0	Issued First	2016.12.01
V 1.1	Window O/D 변경	2017.01.25

Overall View(1:1)

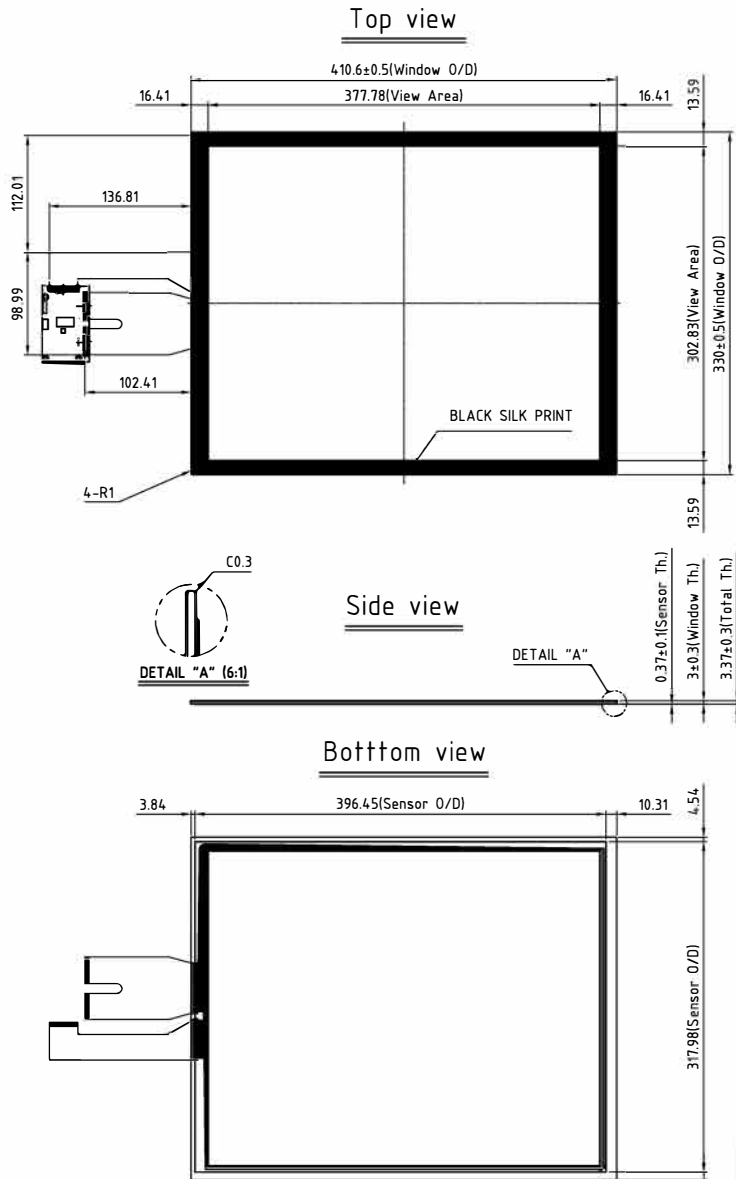

FPCB(1:1)

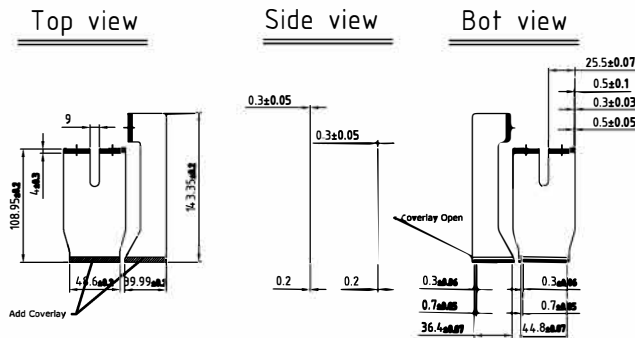

Note

- Material(원단) : 3.0T_Soda Lime
- 도면에 표기되지 않은 공차는 허용공차 Table에 따른 것.
- 투과율 관리 Spec.
 - V/A 투과율 : 80% 이상
 - Coating : AG
 - Haze : 1~5%
 - Gloss : 90~130 unit
- 인쇄부 Spec.
 - Ink material Spec.
 - 1도 : Black
 - 2도 : Black
 - Ink thickness : 20um 이하
- 외관검사 기준.
 - 외관검사 기준서를 따른 것.

Tolerance for linear dimension

Dimension	Tolerance
0.5~6	±0.2
6~30	±0.3
30~120	±0.4
120~400	±0.5
400~1000	±0.9

CHANNEL INFORMATION

	Rx	Tx
2D Area	61	49
Dummy	2	2
GND	2	2
Total	65	53
Pitch(mm)	6.24	6.24

Model No.	CSM190SH				Product No.	CSM190SH							
Part No.	-				Q'ty	-							
TOLERANCE (±MM)	Dim	6	30	120	400	1000	PROJECTILE	SCALE	UNIT	SIZE	DATE		
	Class	-6	30	-120	-400	-1000						3RD ANGLE PROJECTION	
	A	0.05	0.1	0.15	0.2	0.3							0.5
B	0.1	0.2	0.3	0.5	0.8	1.2	1/5	mm	A3	2017.01.25			
C	0.2	0.5	0.8	1.2	2	4	DRAWING NAME	CSM190SH					
	DESIGNED	CHECKED	APPROVED	DRAWING NO.									
								SHEET NO.				SHEET 1 OF 1	